

Fall 12-1-2012

## The Protestant Reformation and Interior Church Architecture - Art Exhibition

Winston Kam  
*Case Western Reserve University*

Catherine Scallen  
*Case Western Reserve University, cbs2@case.edu*

Follow this and additional works at: <https://commons.case.edu/intersections-fa20>



Part of the [History of Art, Architecture, and Archaeology Commons](#)

---

### Recommended Citation

Kam, Winston and Scallen, Catherine, "The Protestant Reformation and Interior Church Architecture - Art Exhibition" (2012). *Intersections Fall 2020*. 11.  
<https://commons.case.edu/intersections-fa20/11>

This Book is brought to you for free and open access by the Intersections: CWRU Undergraduate Poster Session at Scholarly Commons @ Case Western Reserve University. It has been accepted for inclusion in Intersections Fall 2020 by an authorized administrator of Scholarly Commons @ Case Western Reserve University. For more information, please contact [digitalcommons@case.edu](mailto:digitalcommons@case.edu).

# The Protestant Reformation and Interior Church Architecture - Art Exhibition

Winston Kam<sup>1</sup>, Catherine Scallen<sup>1</sup>

<sup>1</sup> Department of Art History and Art, Case Western Reserve University, Cleveland, OH



## Abstract

The first half of the 16th century saw an international religious and cultural conflict that rose within Western Christianity between Roman Catholics and the newly established Protestants. A profound disagreement between the two doctrines lie within the display of religious images in church settings.

This exhibition aims to explore the transition of church elements and design through a replication of the first Protestant church and Catholic cathedral, along with a selection of artworks seen within these sacred spaces or related to the region.

Through an analysis of visual elements present within the Brussel Cathedral and the Torgau Castle Chapel, conclusions can be drawn about this initial religious impetus to help explain how some Northern Europeans conceived of their religious spaces to accommodate a changing belief system. A supplemental collection of objects and artworks from a number of locations will further illustrate the Protestant Reformation's effect on Northern European Renaissance art. Ultimately, this comprehensive exhibition space mockup touches upon both aspects of exhibition design and curatorial work.

## Floor Plan

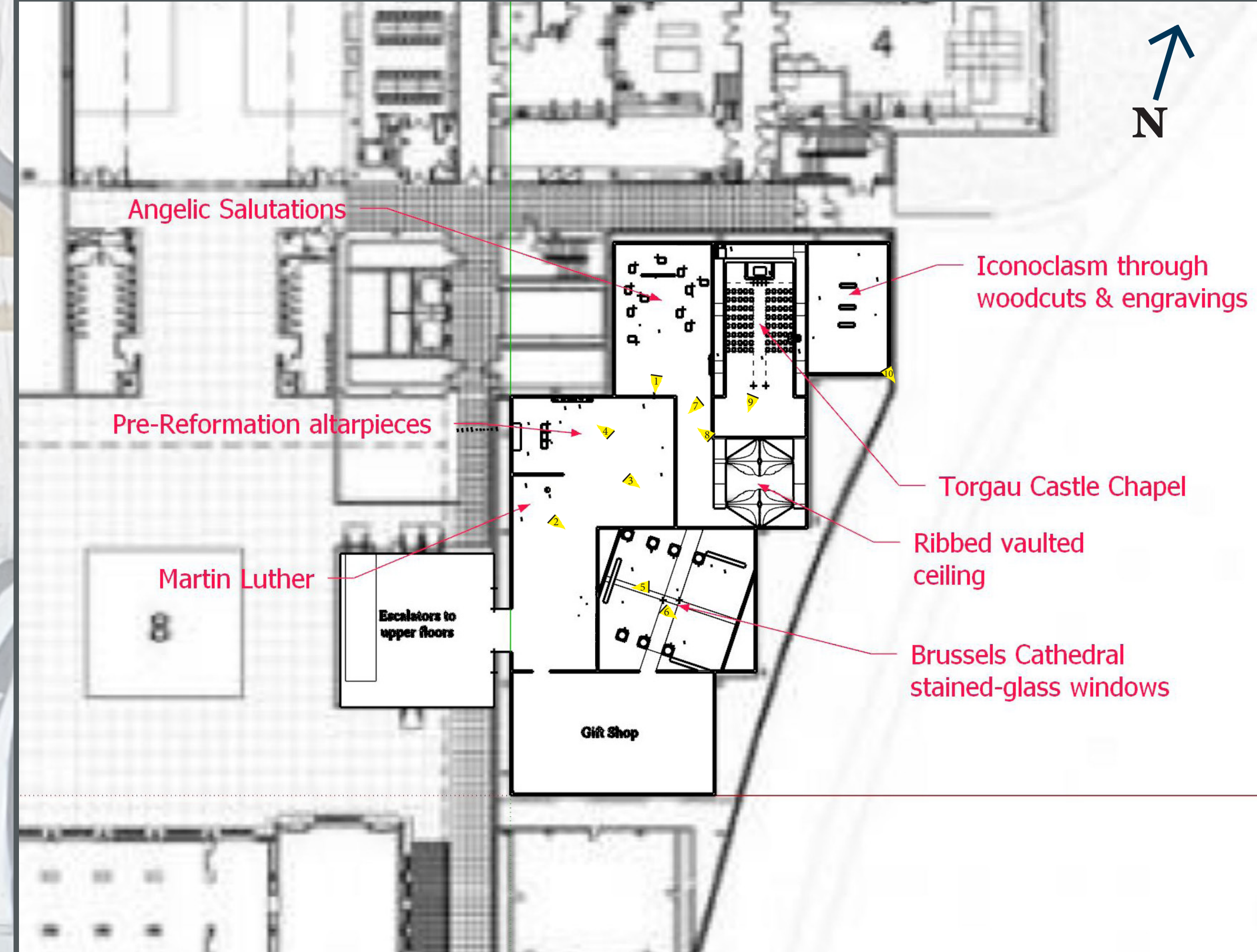

## Notable Select Artworks

- [1] Nickolaus Gromann (1500-1566), Lucas Cranach (1472-1553), *Hartenfels Castle Chapel*, 1544, Castle Hartenfels, In situ Torgau, Germany
- [2] Veit Stoss (1449-1533), *Angelic Salutations*, 1517-18, Polychromed lime wood assemblage, 5.15m dia., In situ St. Lorenz, Nuremberg
- [3] Jan Haeck (-), Bernard van Orley (1487-1541), *Stained-glass windows from the Cathedral of St. Michael and St. Gudula*, 1528 center window, 1537-38 north-south windows, In situ Brussels, Belgium
- [4] Rogier van der Weyden (1400-1464), *Saint Columba Altarpiece*, 1455, Oil on oak wood panel, mid panel 138x153cm, side panels 138x70cm, Alta Pinakothek, Munich
- [5] Lucas Cranach (1472-1553), *Hunt at the Castle of Torgau in Honour of Charles V*, 1544, Oil on panel, Museo del Prado
- [6] Hans Baldung (1484-1545), *Portrait of Martin Luther*, 1521, woodcut, Acta et res gestae
- [7] Frans Hogenberg (1540-1590), *The Calvinist Iconoclastic Riot of August 20, 1566*, 1588, copper engraving, British Museum, London
- [8] Jan Luyken (1730-1738), *Beeldenstorm*, 1566, etching, 271mmx345mm, Rijksmuseum, Amsterdam

## References

- [1] Deac. Carolyn S. Brinkley, "Hartenfels Castle Chapel, Torgau, Germany: The First Lutheran Church Structure," *The Lutheran Church* (2017)
- [2] Christy Anderson, *Renaissance Architecture* (Oxford History of Art) (2013), 33-35
- [3] <https://tic-torgau.de/experience-torgau/discovery-and-culture/sehenswert/hartenfels-castle/torgau-castle-chapel/?lang=en>
- [4] Jeffrey Chipps Smith, *The Northern Renaissance* (2013), 352 - 354
- [5] <https://cathedralisbruxellensis.be/en/history/>
- [6] Jerry Dwyer, "The Stained Glass Windows of St Michael and St Gudula," *Crow Canyon Journal* (2013) <https://crowcanyonjournal.wordpress.com/2013/08/21/the-stained-glass-windows-of-st-michael-and-st-gudula/>
- [7] Rogier van der Weyden, *Columba Altar: Adoration of the Magi*, around 1455, Bayerische Staatsgemaldesammlungen - Alte Pinakothek, Munich, URL: <https://www.sammlung.pinakothek.de/en/artwork/jWlpO7nxKY> (Last updated on April 21, 2020)
- [8] Alfred Acres, "The Columba Altarpiece and the Time of the World," *Art Bulletin*, Sep 1998, vol 80, no. 3

## Selected Views of Exhibition Space

